

# DEFENDER Cab™



## Defender Cab™ Owner's Manual

Model:

Kioti Mechron 2200

### **Caution:**

Before using this product, read this manual and follow all safety instruction



## For Kioti Mechron 2200

- 
- **Safety Instructions**
- **Kit Contents**
- **Tool Requirement**
- **Assembly Instructions**
- **Additional Notes**

\* Defender cabs and accessories are in no way affiliated with Kioti. Any use of these or there model name(s) is only to identify their vehicle as it pertains to our accessories.

Warning: Failure to heed all safety and operating instructions and / or warnings regarding use of this product can result in serious bodily injury.

## SAFETY INSTRUCTIONS

### **Read entire assembly instructions prior to commencing work.**

Install all parts indicated in assembly instructions. Failure to fully assemble product before use could result in personal injury.

Assembly of product requires use of hand and/or power tools. If you are not experienced in using these types of tools, have product dealer do the installation for you.

Some parts contain sharp edges; wear protective gloves if necessary.

Dress for safety. Do not wear loose clothing, neckties or jewelry if using power tools to assemble this product.

Always keep your assembly area clean, uncluttered and well lit.

Keep visitors and children a safe distance away from the assembly area. Visitors should wear the same safety equipment described above.

**NEVER OPERATE YOUR VEHICLE WITH THE CAB DOORS OPEN. FAILURE TO PROPERLY LATCH THE DOORS PRIOR TO MOVING THE VEHICLE COULD RESULT IN SERIOUS INJURY.**

### **Additional Safety Note(s):**

Some optional installation steps require that some fasteners pertaining to safety devices be temporarily removed. By choosing to perform these steps, you are doing so at your own risk and accept full responsibility should these safety devices fail due to your tampering with them. Please consider the full extent of possible repercussions when choosing to remove any safety device such as nets, safety belts and ROPS.

# Cab Enclosure Kit Contents

Your **Defender™ Cab Enclosure Kit** should contain the parts listed below. Separate all parts from packing materials. Do not discard packing material until assembly is complete. Item quantities are listed in parenthesis below. *Note:* Items listed below may or may not be included based on selected options or may be already installed.

## Panels, Doors and Brackets

- (1) 31031 Front panel assy.
- (1) 31032 Roof panel assy.
- (1) 31033 Back panel assy.
- (1) 31039 Driver back side assy.
- (1) 31005 Driver header panel
- (1) 31040 Pass. back side assy.
- (1) 31007 Pass. header panel
- (1) 31034 Driver door assy.
- (1) 31035 Pass. door assy.
- (2) 31013 Back panel door sile
- (1) 31015 Driver lower filler
- (1) 31019 Pass. lower filler
- (1) 31017 Pass. side fuel pod spacer
- (2) 31020 Side clamp assy.
- (1) 31021 Driver latch bolt bracket
- (1) 31022 Pass. latch bolt bracket
- (1) 31023 Driver floor spacer
- (1) 31024 Pass. floor spacer
- (4) 20100 Rear panel hinge plate

- (4) 20101 Door hinge plate and damper bracket
- (4) 20102 Side panel damper bracket

## Hardware

- (1) 31030 Hardware bag\*
- (6) 10108 Rubberized clamp 1 3/4"
- (4) 11087 Door strap
- (4) 11088 Buckle
- (1ft) 11017 Edge trim 5/8" side bulb
- (23ft) 10034 Small protective trim
- (28ft) 11124 Edge trim 5/8" end bulb
- (1) 10045 Left inside latch c/w bolt
- (1) 10093 Right inside latch c/w bolt
- (2) 10048 Push button outside handles
- (4) 10368 Push pins for door limiter
- (2) 10607 Left lift off hinge
- (2) 10606 Right lift off hinge
- (1) 10106 roll soft gasket
- (2) 11114 Rectangular louver

\*NOTE: Hardware bag contains spare items. Some items may or may not be used in this application.

## Tools Required for Assembly

Ensure that you have the following tools available before you begin the assembly of your **Defender Cab™** Enclosure Kit. **\*\*\* Assembly May require an assistant \*\*\***

**NOTE:** Stainless Steel hardware **WILL** gall (seize) without use of anti-seize compound

- Phillips & Flat screwdrivers
- 1/8" and 5/32 Allen Key (provided)
- Metric/Standard wrench and socket sets
- 5/16" drill bit
- Utility knife
- Utility clamps (Suggested)
- Rubber Mallet (Suggested)
- Anti-Seize Compound or Lubricant
- Side cutters

# Kit Installation

## 1. Panel Preparation and installation

i) Install 5/8" bulb rubber moulding along front panel edge that will sit on the front of the bike fig.2. Use 6 rubberized clamps to attach front panel to roll bar fig.1. Use 6X 3/4" 10-32 button head screws with lock nuts and washers on the inside.

Fig.2

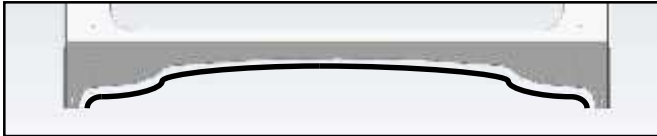
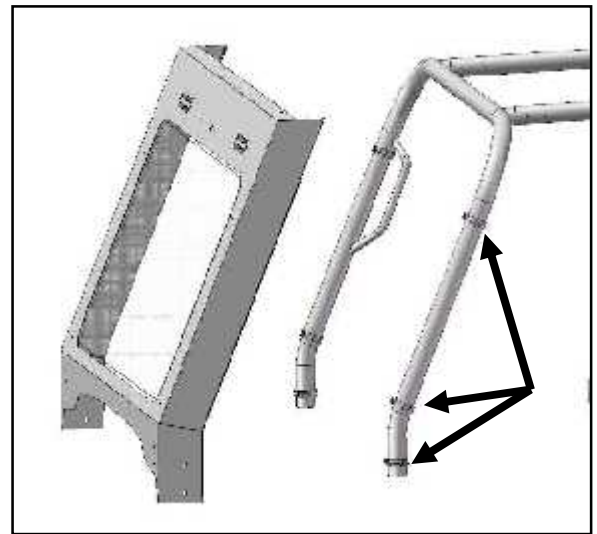

Fig.1



ii) Install Male hinges on Driver "shown" & Pass. back side panels fig.3. Use 8X 1/4-20 Flat head screw. Do not lose the bushing washers that comes with the hinges. Panel hinge plates are used on the back side instead of nuts. Make sure to install plates with the smooth face against the rear panel. This will allow your door to adjust up and down fig.4.

Fig.3

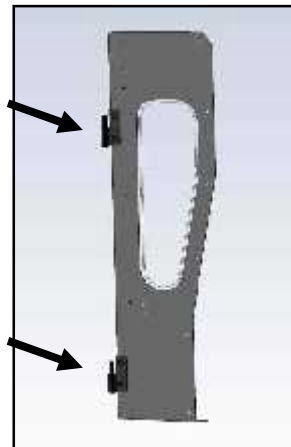
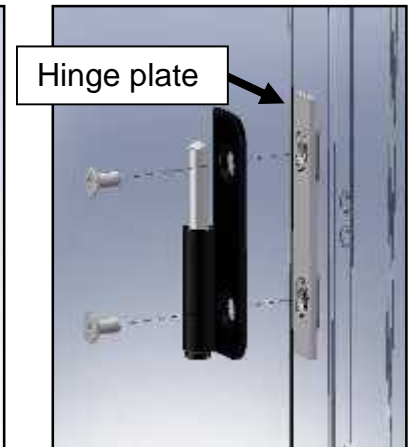

Fig.4



iii) Attach 2X back panel Door sile & Driver/Pass. header panels to side back panels fig.5. Use 12X 1/2" 1/4-20 Button head screws and serrated flanged nut for fasteners showing on the outside, and 12X 1/2" 1/4-20 Button head screws with 1/4" washers on the inside where insert nuts are located. This assembly method is used throughout the assembly.

Fig.5

\*Also attach 4X side panel damper bracket. Use 8x 1/4-20 button head screws (they will be used later to attach straps for limiting door opening) 2 per side.

Damper bracket

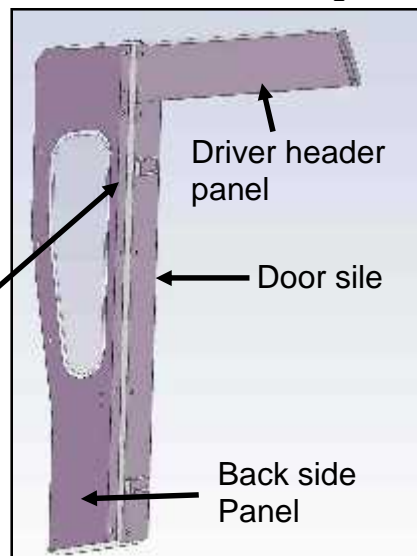
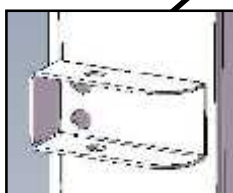
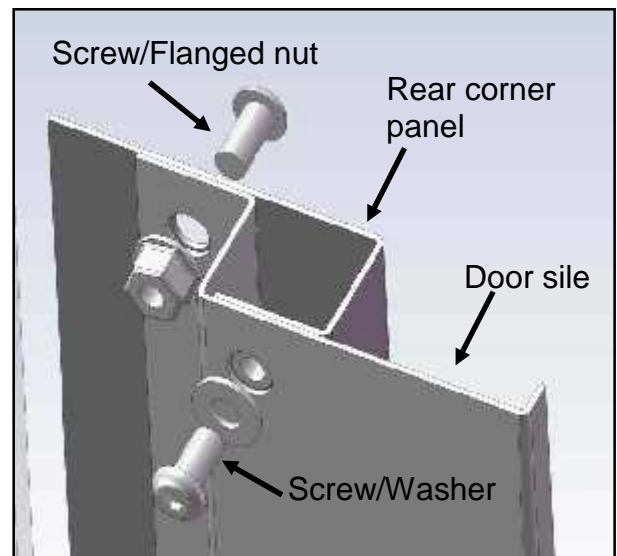

Fig.6

**Cross section View from inside the cab**



iv) Attach back side panel assemblies to front panel fig.7, and to bar clamps fig.8. 1/2" Stick on foam can be added to the bottom of back side panel where it will meet the bike fig.8. Bar clamps are designed to be able to adjust the back section side to side so that the dump box lines up with the notch at the bottom of the back panel. Leave the bolts loose until the back panel is installed.

Fig.7

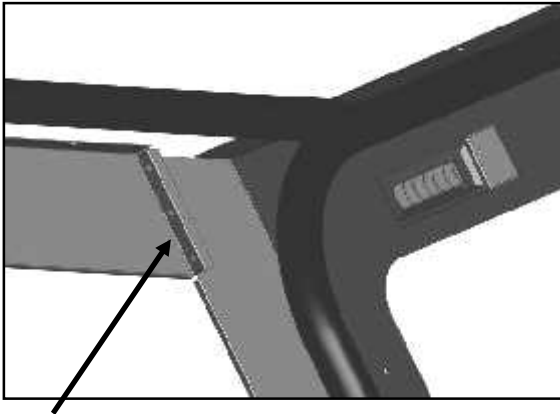

6X 1/2" 1/4-20 Screw/Flanged nut

Fig.8

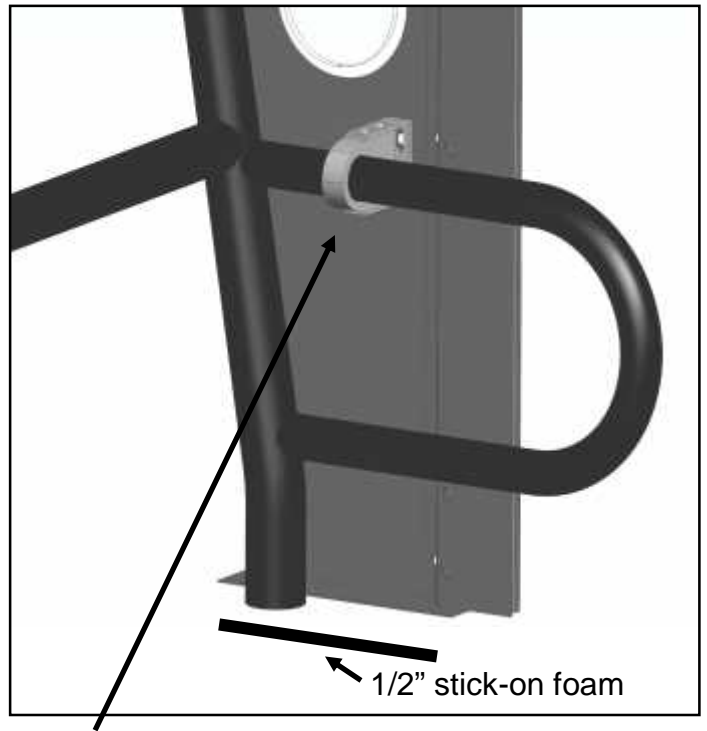

4X 1/2" 1/4-20 Screw/Flanged nut  
 4X 2 3/4" 5/16-18 Screw/ lock nuts  
 8X 5/16 washer

v) Install Driver and Pass. front lower fillers. Remove the two fasteners shown in fig.9. and use them to attach the lower fillers fig.10. Fillers get tucked inside the front panel and fastened with 4X 1/2" 1/4-20 button head screws with flanged nuts. Install striker bolt brackets and striker bolts fig.11. Use 4X 1/2" 1/4-20 button head screws with flanged nuts.

Fig.9



Fig.10

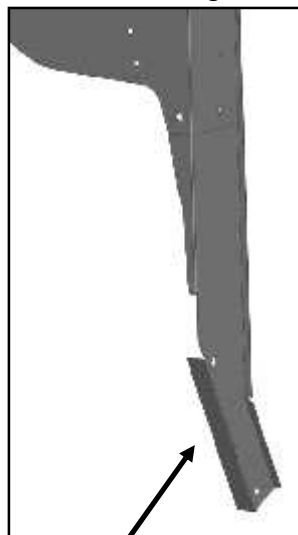

Driver lower filler

Per side  
 1X Striker bolt  
 2X Yellow zinc washer

Fig.11

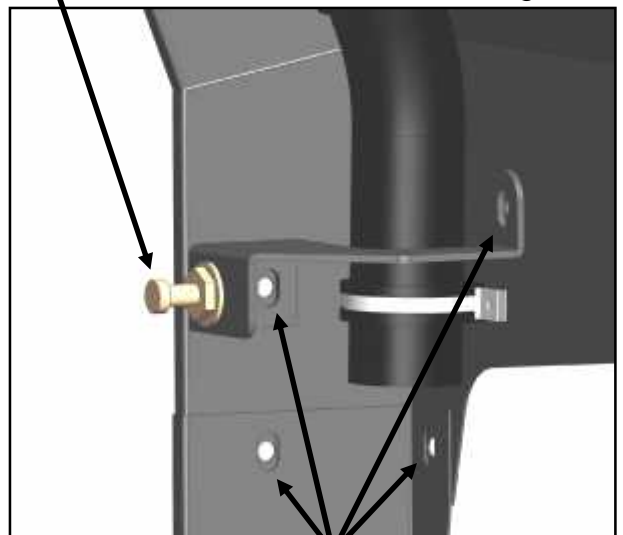

8X 1/2" 1/4-20 Screw/Flanged nut

**vi)** Install the back panel. It sits between the two back side panels fig.12. Use 12X 1/2" 1/4-20 button head screws and flanged nuts to attach the back panel to back side panels. Loosen the bolts on the roll bar clamps and move the back assembly so that it's centered side to side and so both door side faces line up with the bikes side plastic components. The dump box locking mechanism should also line up with the notch in the back panel. Tighten the bolts on the side roll bar clamps.

**\* If Console accessories is purchased drop on top between rool bars before attaching roof. See Console /heater instruction.**

**vii)** Drop the roof in position. Use 16X 1" 1/4-20 button head screws with rubber washers and flange nuts on the outside edges of roof fig.13. If there is no roof console to install Use 3X 3/4" 1/4-20 button head screws with rubber washers, 1/4" washer and flanged nut to seal the 3 center holes fig.14.

**viii)** Install the Pass. side fuel pod spacer and the Driver/Pass floor spacers fig.15/16. Remove the existing fasteners on the bike and use to attach the parts fig.15. These parts are there to get a better seal with the doors

Fig.12



Fig.13



Fig.14



Fig.15

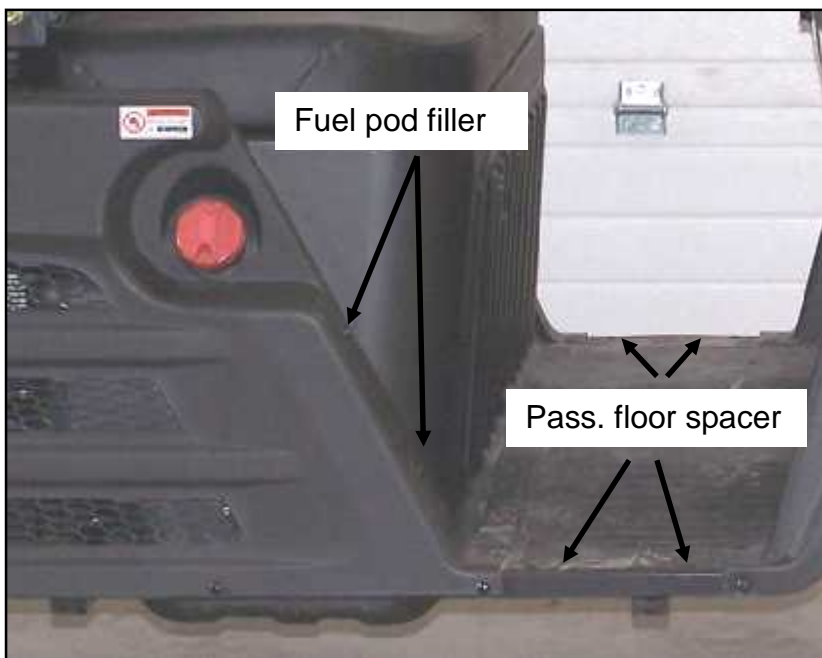
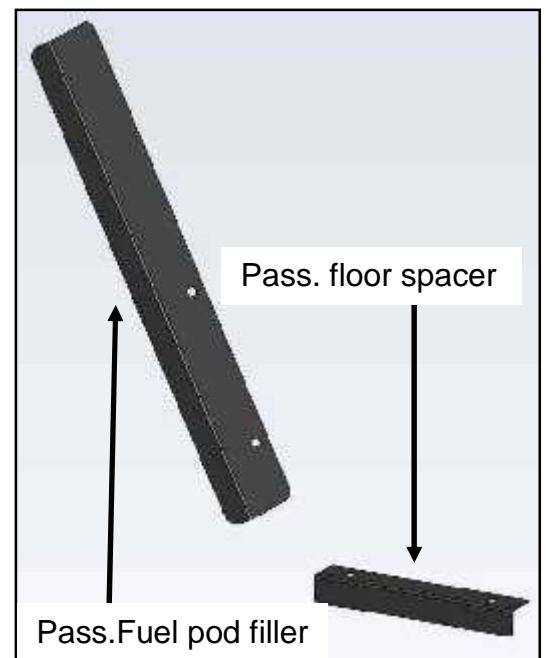

Fig.16





**ix)** Small protective trim is supplied to run around the door jam outside lip.fig.17.

Fig.17

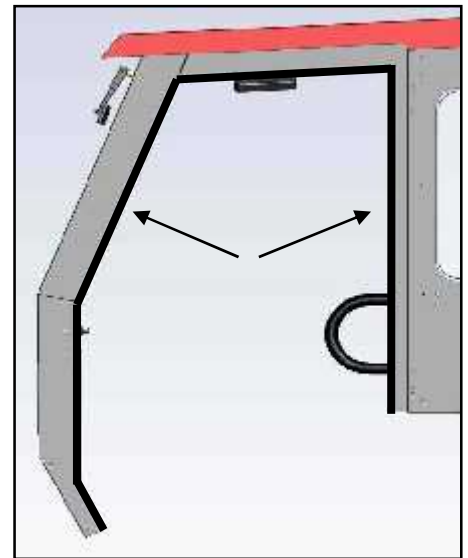

**x)** Doors come with all hardware installed fig.18/19. Use 4X 2" 1/4-20 bolt, 8 washers and lock nuts on each door damper bracket to hold strap and buckle fig.20. Lock pin are supplied for the back side panel damper bracket for quick removal of the doors fig.21.

Fig.18

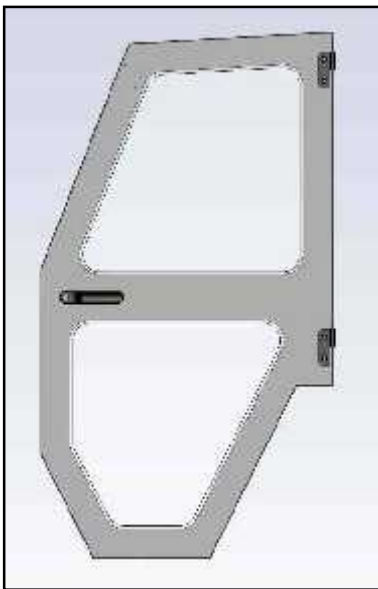
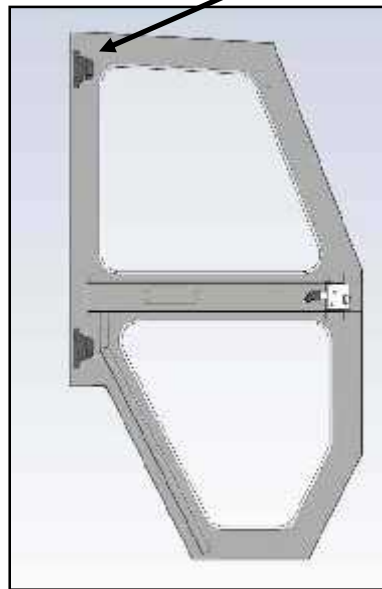

Fig.19



Door hinge plate with damper bracket

Fig.20

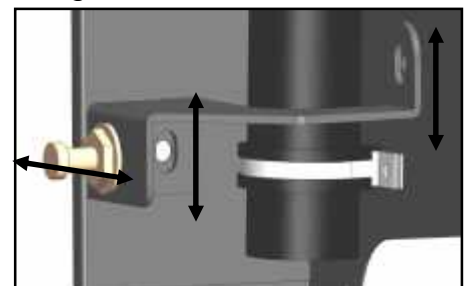

Fig.21



**xi)** The doors can now be dropped in place and adjusted .There should be appx. 1/4" gap between door and back. 1/4" spacers can be used to hold the door in position before tightening screws. Back hinge moves up and down and door hinge moves front to back. Striker bolt bracket can be adjusted up and down fig.22 once the door is in position. Striker bolt will need to be adjusted in and out fig.22 so door closes properly with a tight seal. Door might need to be adjusted again to get a proper fit.

Fig.22



**xii)** Install wiper motor as seen in fig.23. Use 10-32 button head with lock nut. Never push wiper arm on motor's shaft all the way until it's at the right angle for maximum wipe. Once it pushed all the way in it's extremely hard to take back off

Adjustment to wiper sweep angle and "home" position can be made by removing cover and following the manufacturer's instruction printed on box. Run wiring along top incased in wire loom and hang of roof fasteners with plastic clips.

Note: Motors are normally shipped at maximum sweep angle of 110 deg.

Fig.23



**\*A switch box is provided if console unite is not purchased. It's mounted on the driver side next to the roll bar fig.25. Use 4X 10-32 button head screws, 4 washers and lock nuts. The switch box has 2 rocker switches that can be used to add accessories like ext. lights etc. The two speed switch is used for the front wiper and the other can be used for a under the dash mount heater switch.**

Fig.25

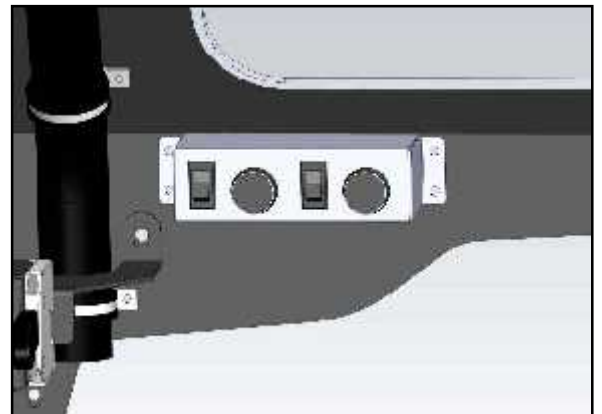



## Additional Note(s):

- a) Removal of belts and/or nets is not recommended as this cab enclosure is **not** designed as a roll over protection system. Always wear proper safety gear while riding your UTV.
- b) To remove doors, simply remove damper bracket lock pin's and lift doors off
- c) Visit *Defendercab.com* regularly for updates and newly added items to fit your UTV cab.
- d) Wash enclosure with soapy water as you would any other vehicle.
- e) Hooking up power to ignition is recommended, that way added components won't drain battery when tractor is turned off if accessory is left on. Only Authorised dealers should tamper with UTV's electrical components.

To order replacement parts, contact the Parts Department at:

LB Manufacturing Inc.

247 Arsenault Road, Dieppe,

N.B. Canada E1A 7J5

Ph: (506) 388-9334 Fax (506) 388-3325

Toll Free: 1-877-380-3335

[www.defendercab.com](http://www.defendercab.com)

[parts@defendercab.com](mailto:parts@defendercab.com)

Manual Revision: 1.0

Date: 12 Dec, 2012

- Nylon insulated butt splice 22-18 awg 10303-01 X2
- Female terminal quick connect 22-18 awg 10259-01 X7
- Female terminal quick connect 14-16 awg 11139 X1
- Female bullet connector 22-18 awg 10301-01 X5
- Ring connector 22-18 awg 10633 X2
- ACG inline fuse holder 11095 X2

### LBM # 31041-01

**Notes:**

- Wires with connector should be kept in kits but not taped together
- Wire lengths are approx. +/- 1/4"

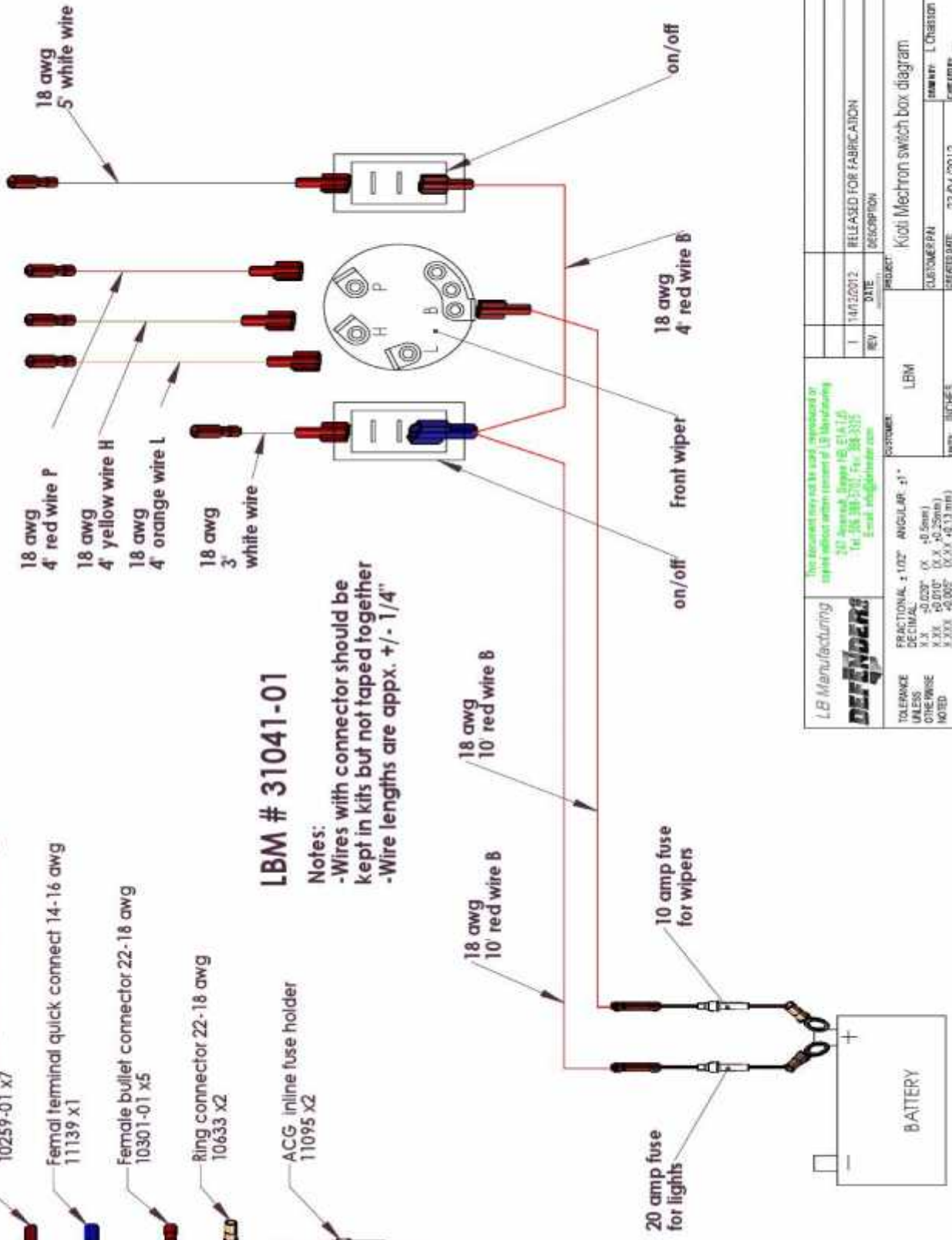

L.B. Manufacturing		<small>This document may not be used, reproduced or copied without written consent of L.B. Manufacturing</small> <b>DEFENDERS</b> <small>212 Approach Street (Bldg. 21A) Ft. Belvoir, WA 98115          Email: info@lbfab.com</small>	
REV	DATE	DESCRIPTION	PRODUCT
1	11/12/2012	RELEASED FOR FABRICATION	LBM
CUSTOMER: Kioti Mechron switch box diagram		DESIGNED BY: L. ORSHAN	DRAWN BY: L. ORSHAN
DATE: 23/04/2012		SCALE: NTS	
SHEET NO. 1 OF 1		SCALE: NTS	

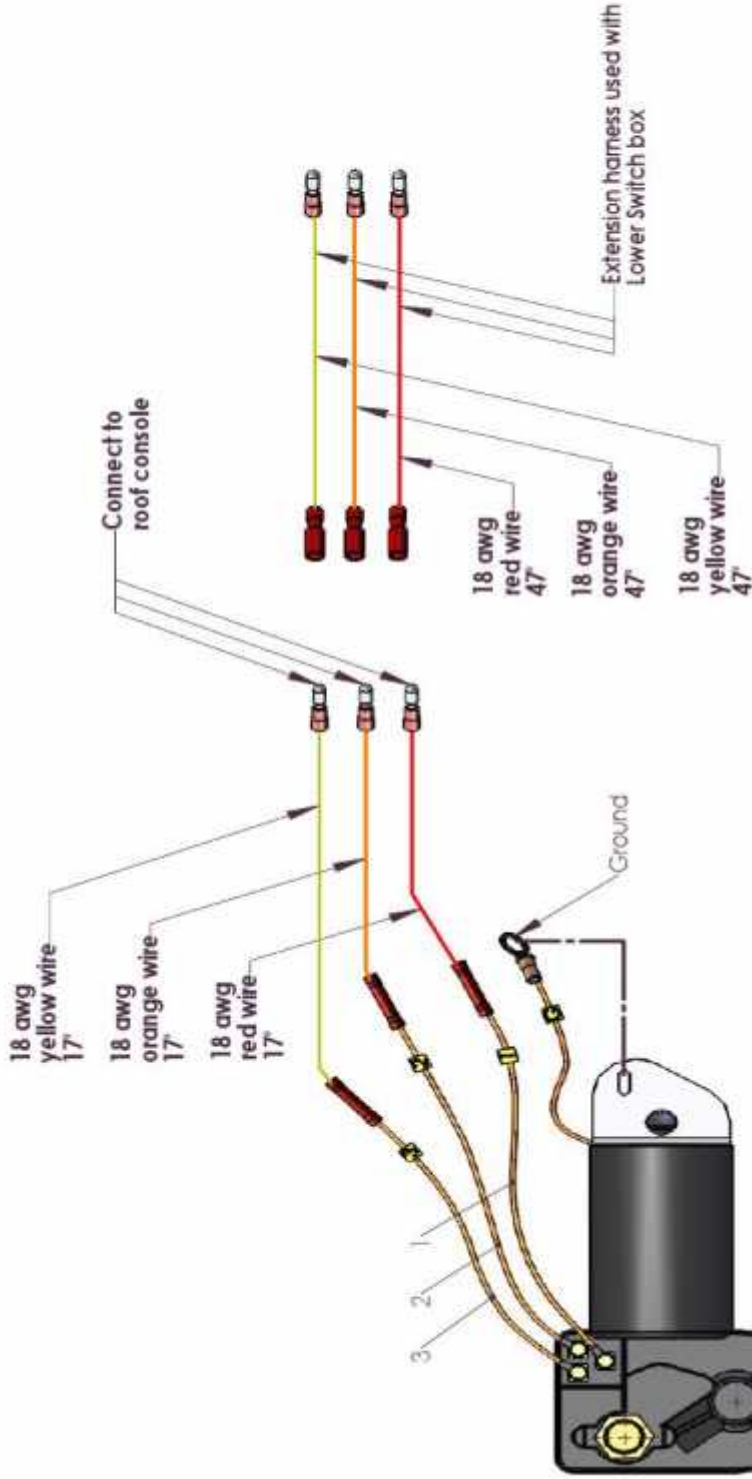

### Kioti Mechron cab Front Wiper harness lbm# 31042-01

**Notes:**

- Wires with connector should be kept in kits but not taped together
- Wire lengths are appx. +/- 1/4"
- Make sure to properly ground to cab .Remove a bit of powder coat to get metal to metal contact

- Female bullet connector 22-18 awg 10301-01 x3 per wiper
- Male bullet connector 22-18 awg 10302-01 x6 per wiper
- Ring connector 22-16 awg 5/16" 10633 x1 per wiper
- Nylon insulated butt splice 22-18 awg 10303-01 x3 per wiper

<p><i>This document may not be used, reproduced or copied without written consent of LB Manufacturing</i>  <b>247 Avenue, Opaoka, PA 17225</b>                  Tel: 717-398-3300 Fax: 717-398-3315                  Email: info@lbmfg.com</p>		<p>RELEASED FOR FABRICATION</p>	
REV.	DATE	DESCRIPTION	PROJECT
1	1/31/2012		Kioti Mechron wiper harness
<p>TOLERANCE UNLESS OTHERWISE NOTED</p> <p>FRACTIONAL ± 1/32" ANGULAR .1°</p> <p>DECIMAL .015mm (X), .05mm (X.X), .0100" (X.X), .025mm (X.XX), .005" (X.XX)</p>		CUSTOMER	DATE
		LBM	23/04/2012
		UNITS: INCHES	SCALE: NIS
		CUSTOMER PART	DESIGNED BY
			L. CHRISTIAN
		CHECKED BY	